

**POT BEARING HOUSING ASSEMBLIES
FOR VOLKMANN MANUAL & AIR THREADED POTS
07-08-09 (NOT 09ST), BA1, BA2, AND BA3
REBUILD & EXCHANGE SERVICE**

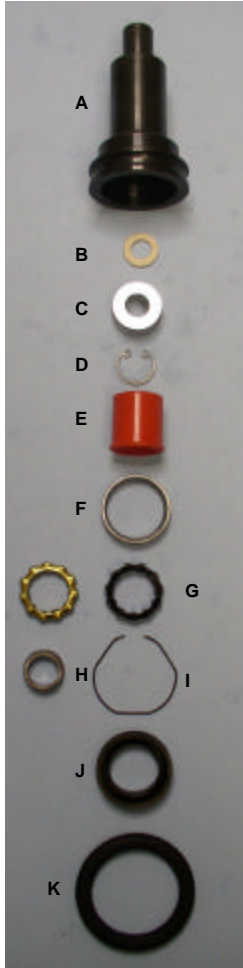

REBUILDING POT BEARING HOUSINGS: The used assembly is disassembled, cleaned and inspected. Epic **always** replaces the felt sealing washer (B), upper needle bearing (C), nylon spacer bushing (E), lower outer race (F), bearing cage (G), and wire retaining ring (I). Any static parts that show wear or faults are also replaced. The rebuilt assembly is lubricated with Kluber synthetic grease.

The rebuilt pot bearing housings function “like new”, at a significant savings to the customer.

Because it is good practice to replace the inner race (H) on the upper spindle blade when replacing the lower outer race (F) and cage, polyamide or brass (G), a new inner race (H) is also supplied with the exchange or rebuilt assembly when the brass bearing cage is used.

- (A) Outer Steel Shell: EE480734
- (B) Top Felt Washer : EE480739
- (C) Needle Bearing: EE402002
- (D) Internal Retaining Ring EE434301 (only on BA1/BA2; not required for rebuild.
- (E) Nylon Spacer Bushing: EE401907-1
- (F) Outer Race: EE401902
- (G) Bearing Cage, Polyamide (EE401903-1) or Brass (EE401903) (Customer to specify)
- (H) Inner Race, supplied with the brass cage bearing: EE401904
- (I) Wire Retaining Ring: EE401906
- (J) Labyrinth Ring: EE401905
- (K) O-Ring: EE435033

| OEM # | Epic # | Description |
|---------------------------|------------|---|
| VTS 07-09, BA1-BA3 | | |
| 070788 908749 | EE440025 | Complete NEW Pot Bearing Housing, with inner race |
| (070788) (908749) | EE402028 | REBUILD Customer's Complete Pot Bearing Housing |
| | EE402028-1 | USED & REBUILT Complete Pot Bearing Housing, for Exchange |
| | EE402028-2 | REBUILT FOR SALE, Complete Pot Bearing Housing, Rebuilt |

